



MÆRSK INSPIRER



MÆRSK INSPIRER

TYPE

MSC CJ70-150 MC, Ultra harsh environment jack-up drilling rig

BUILT

Hyundai Heavy Industries Co., Ltd., 2004

CLASS

Det norske Veritas

FLAG

Denmark

The **MÆRSK INSPIRER** is one of the ultra harsh environment jack-ups in Maersk Drilling's fleet. With a leg length of 205.3 m (673 ft) the rig is designed for year-round operation in the North Sea, in water depths up to 150 m (492 ft).

THE MAIN FEATURES OF THE MÆRSK INSPIRER INCLUDE:

- High level of safety
- 150 m (492 ft) water depth capability year-round in the North Sea
- Cantilever reach from stern to well centre 30.5 m (100 ft) from centreline to each side 10 m (32.8 ft)
- Combined cantilever load 1,400 t
- Dual pipe handling. While one string is working in the well bore, a second string of i.e. casing, tubing, drill pipe or bottom hole assembly can be assembled/disassembled, ready for subsequent transfer for use in the well bore
- 2,500 m² deck space
- 10,000 t variable load
- Fully mechanised tubular handling
- Dual drilling fluid system for easy change between mud types
- Driller's cabin, fully enclosed, touchscreen and joystick controls
- Computerised drilling systems
- Drilling and work-over through surface or subsea BOP system
- Fully equipped for HP/HT operations
- 18 3/4" 15,000 psi BOP system
- Automated and dust-free chemical mixing system
- Unmanned engine room
- Cuttings slurryfication and reinjection system
- Accommodation for 120 people
- Superior working and living conditions for the crew



MAIN PARTICULARS

DIMENSIONS	IMPERIAL	METRIC
Length overall	291 ft	88.8 m
Width overall	336 ft	102.5 m
Depth	39.4 ft	12 m
Length of legs	673 ft	205.3 m
Cantilever - max. reach: aft of stern to each side of centreline	100 ft 32.8 ft	30.5 m 10 m
Draught	26.2 ft	8 m

WEATHER/DESIGN CRITERIA	IMPERIAL	METRIC
Water depth	492 ft	150 m
Wind speed	95 knots	49 m/sec
Penetration	9.8 ft	3 m
Wave height	95 ft	29 m
Current (surface)	2 knots	1 m/sec
Air gap	82 ft	25 m

PARTICULARS	IMPERIAL	METRIC
Rated drilling depth	30,000 ft	9,150 m
Hook load static w/top drive	2,000,000 lb	910 t
Rotary load	2,000,000 lb	910 t
Setback load	1,808,000 lb	820 t
Variable load	10,000 t	10,000 t
Derrick	210 ft x 46 ft x 52.5 ft	64 m x 14 m x 16 m
Jacking speed	1.6 ft/min	0.5 m/min
Drill water	20,876 bbl	3,319 m ³
Fuel oil	11,183 bbl	1,778 m ³
Nontoxic oil	3,201 bbl	509 m ³
Brine	4,761 bbl	757 m ³
Potable water	3,195 bbl	508 m ³
Liquid mud	9,691 bbl	1,540 m ³
Bulk cement	7,059 ft ³	200 m ³
Bulk mud	8,824 ft ³	250 m ³
Slurryfication tank	1,886 bbl	300 m ³
Accommodation	120 persons	120 persons



DRAWWORKS

Varco AHS-10Q, 4,600 hp. Four AC motors grooved for 1 3/4".

TRAVELLING EQUIPMENT

Maritime Hydraulic split type block, 2 x (4 x 72" sheaves with 3/4" groove). Capacity 910 t.

TOP DRIVE AND PIPE HANDLING

Varco TDS-8SA with pipe handler and block retract system, 750 t capacity. Powered by one air-cooled AC motor. Max. continuous torque 62,500 ft/lb at 90 rpm and max. intermittent torque of 95,000 ft/lb.

Varco PRS-6is pipe racking system with automatic fingerboards.

Varco AR4500 integrated iron roughneck.

Varco fully interlocked zone management system (ZMS).

ROTARY TABLE

Varco RST, 49 1/2" rotary table driven by Rexroth Mr-3600 hydraulic motor. Opening 49 1/2". Max. load 1,000 t.

MUD PUMPS

Three Wirth TPK 7 1/2" x 14", 2,200 hp, rated for 7,500 psi. One Wirth TPK 7 1/4" x 8 1/2" / 800.

CEMENTING EQUIPMENT

Halliburton HCS-25D 15,000 psi wp. On free placement agreement.

WELL CONTROL EQUIPMENT

NL Shaffer 18 3/4" - 15,000 psi consisting of one annular + two double ram preventers.

DrillQuip diverter system, 500 psi.

The BOP stack is prepared for utilisation in subsea mode.

MUD RETURN SYSTEM

Six Rigtech VSM 300 shale shakers, high performance linear motion. Two 1,500 Burgees Magna vacuum degassers. Two Hiller heavyjet centrifuges and two Rigtech cascade desilters. The rig is equipped with a Procon procut slurryfication unit, a holding tank and a Wirth injection pump. The pump is an electrical driven triplex pump with its own power supply.

DRIVE PIPE SUPPORT DECK

Hinged deck for conductor support 15.2 m (50 ft) aft of transom. For sizes 30" to 36".

TENSIONER SYSTEM

Conductor tensioning system consisting of four 100 t hydraulic cylinders vertical and four 25 t hydraulic cylinders horizontal.

DRILLING INSTRUMENTATION

Varco V-ICIS system.

POWER SUPPLY

Four MAN B&W Holeby 9L27/38. Continuous output 2,650 kW at 720 rpm each driving one Hyundai H5J7 807-16K diesel generator, 3,975 kVA, 6.6 kW and 60 Hz.

CRANES

Two Kenz EHC 100/3500 OS cranes, 48.8 m (160 ft) boom, 50 t capacity to boat. 100 t capacity deck to deck.

One Kenz EHC 100/3500 OS crane, 42.7 m (140 ft) boom, 50 t capacity to boat. 100 t capacity deck to deck.

HELICOPTER DECK

22.6 m (74 ft) diameter helicopter deck suitable for Sikorsky S-61N helicopter.

SAFETY EQUIPMENT

Lifesaving and fire fighting equipment in accordance with Danish Maritime Authority, U.K. DOE/DOT and Norwegian regulations, draft of IMO MODU code 1989. The rig holds a vessel specific safety case which has been approved by HSE UK.

ACCOMMODATION

Accommodation is located in two blocks shaped as a "V", wrapped around the forward leg. Port block is a quiet area with cabins - starboard block holds all offices, recreation rooms and service facilities.

120 persons in two-man rooms with full facilities. 14 offices. Three recreation rooms.

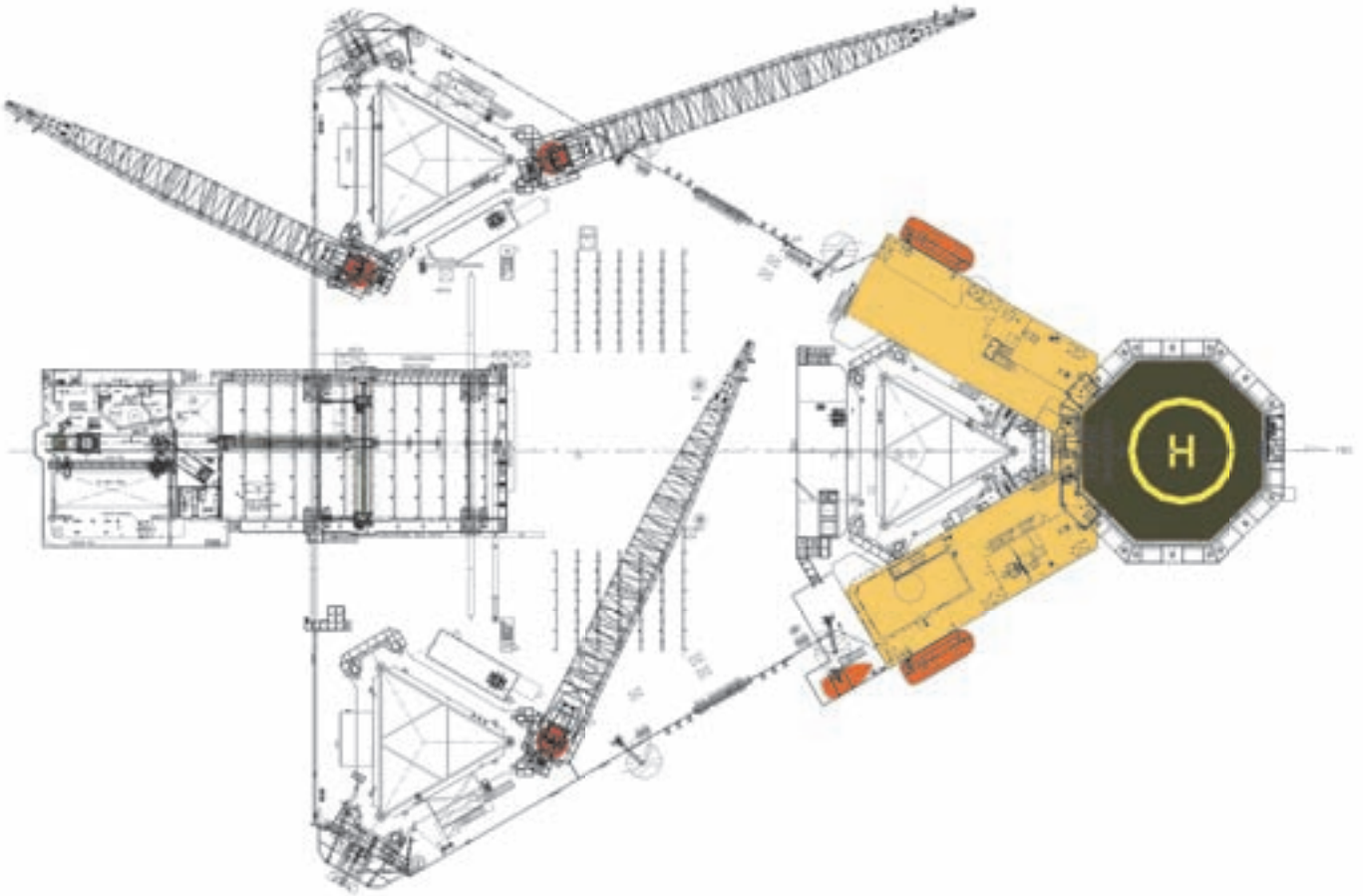

LOWER DECK

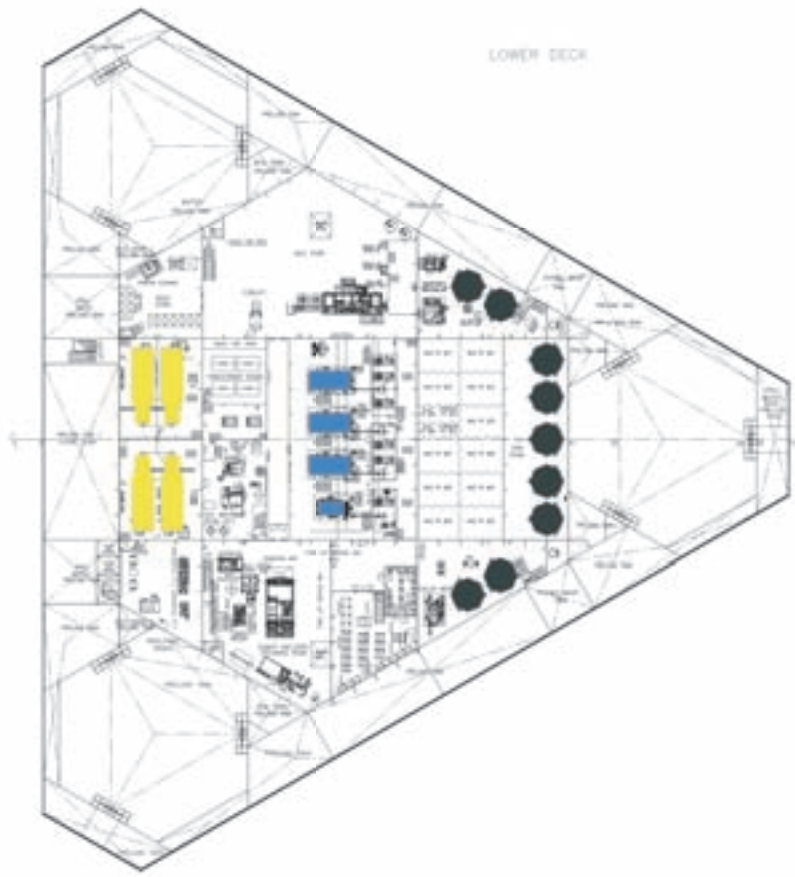

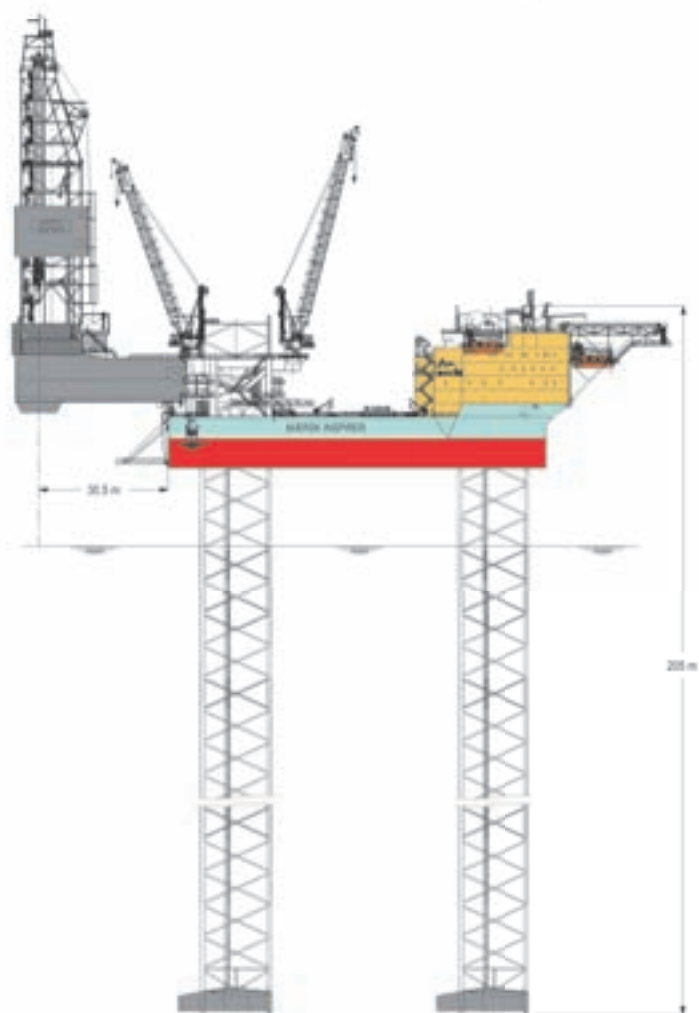
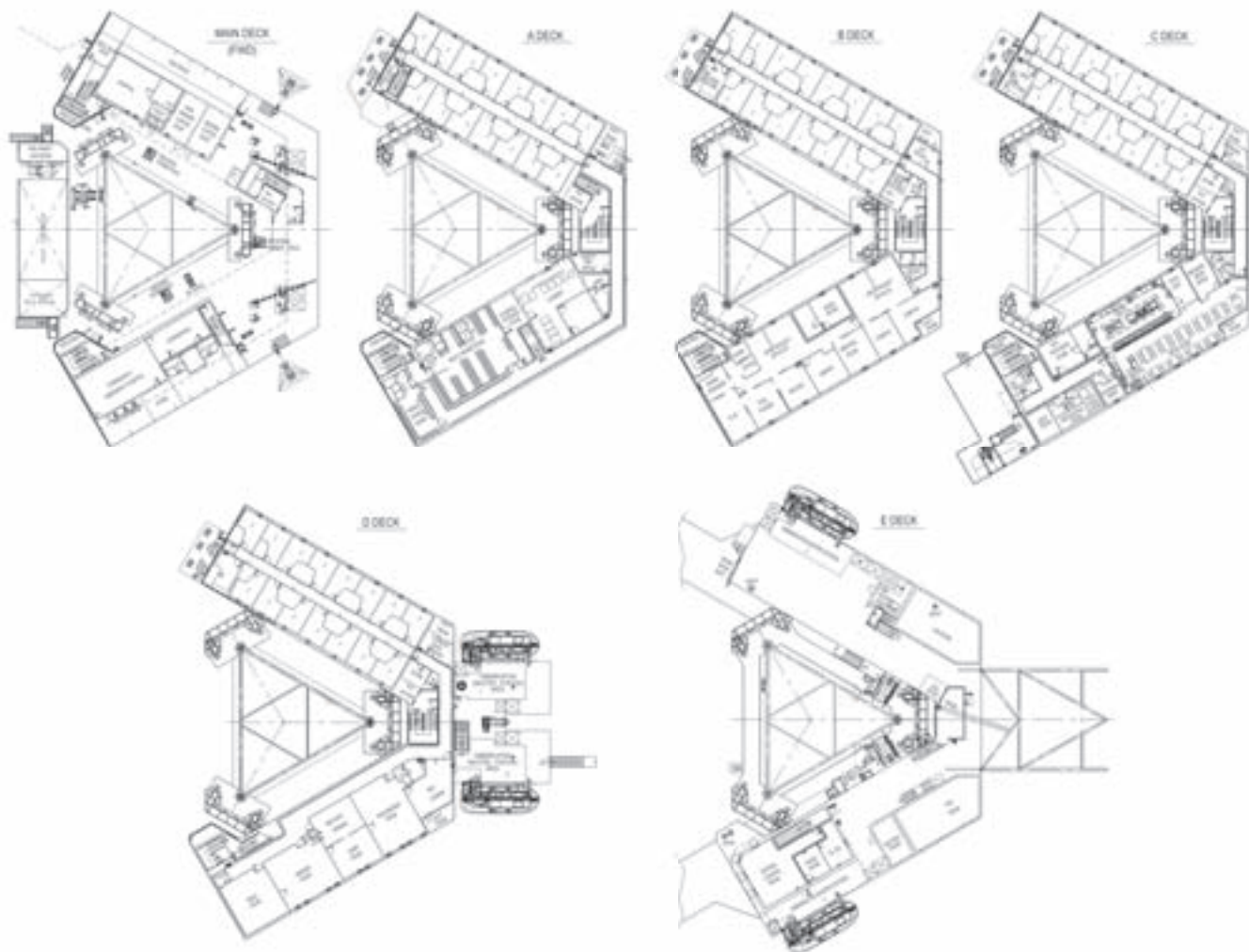

Head office:

Maersk Drilling

50, Esplanaden
1098 Copenhagen K
Denmark

Telephone: +45 3363 3363

Telefax: +45 3363 3182

E-mail: copenhagen@maersk-
drilling.com

www.maersk-drilling.com



August 2008

Maersk Drilling, Esbjerg

1, Kanalen
P.O. Box 239
6701 Esbjerg
Denmark

Telephone: +45 76 14 77 00

Telefax: +45 76 14 77 32

E-mail: esbjerg@maersk-
drilling.com

The Maersk Company Ltd.

Maersk Drilling

Maersk House
Crawpeel Road
Altens Industrial Estate
Aberdeen AB12 3LG
United Kingdom

Telephone: +44 1224 243100

Telefax: +44 1224 243213

E-mail: aberdeen@maersk-
drilling.com

Maersk Drilling Norge AS

Christian August Thorings veg 9
P.O. Box 134 Forus
4065 Stavanger
Norway

Telephone: +47 52 01 70 00

Telefax: +47 52 01 70 01

E-mail: norway@maersk-
drilling.com

Maersk Drilling, Baku

9th Floor ISR Plaza Business Center
340 Nizami Street
Baku 370000
Azerbaijan

Telephone: +994 12 4978450

Telefax: +994 12 4978467

E-mail: baku@maersk-
drilling.com

Maersk Drilling, Venezuela

Edificio MCVSA
Muelle Terminales Maracaibo
Las Morochas
Estado Zulia
Venezuela

Telephone: +58 265 6 401500

Telefax: +58 265 6 410583

E-mail: venezuela@maersk-
drilling.com

Maersk Drilling Australia Pty Ltd

Level 1, 1 Preston Street
Como, WA 6152
Australia

Telephone: +61 8 6436 1400

Telefax: +61 8 6436 1444

E-mail: perth@maersk-
drilling.com

Maersk Drilling (UAE) FZE

LB18, 26th floor, Jebel Ali Free Zone
P.O. Box 262476
Dubai

United Arab Emirates

Telephone: +971 4 8865 770

Telefax: +971 4 886 5679

E-mail: dubai@maersk-
drilling.com

Maersk Drilling USA Inc.

2500 City West Boulevard
Suite 1850
Houston
Texas 77042
USA

Telephone: +1 713 346 4300

Telefax: +1 713 783 9409

E-mail: houston@maersk-
drilling.com

Maersk Drilling Services A/S, Brunei

Brunei Branch Lot 7272
Simpang 73, Sungai Duhon
Light Industrial Area
Kuala Belait KA3131

Negara Brunei Darussalam

Telephone: +673 223 9955

Telefax: +673 223 9958

E-mail: brunei@maersk-
drilling.com